

M61: 適用於吊運車廂中的廢鋼鐵和鑄鐵錠。

M61: Suitable for lifting and transferring cast ingots and steel scraps in box-shaped cart.

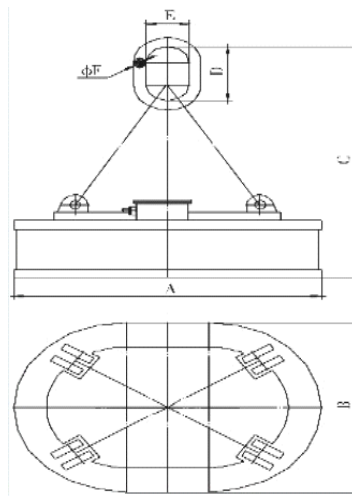

主要技術參數 Main technical data

型號Model	電壓 (V) Voltage	電流 (A) Current	功率 (kw) Power	起重能力 (kg) (冷態/熱態) lifting capacity (cold/hot state)		品質 (kg) Mass	外形尺寸 (mm) Overall dimension					
				鋼球 steel ball	切屑 steel scrap		A	B	C	D	E	F
M61-150110L/1	DC-290/200	78/54	22.6/10.8	1500/1200	800/700	2500	1500	1100	1240	250	175	50
M61-180160L/1-75		113/78	32.7/15.5	2550/2000	1150/900	5000	1800	1600	1500	310	210	60
M61-200150L/1-75		109.8/75.7	31.9/15.2	2200/1900	1000/800	4200	2000	1500	1300	250	180	70
M61-250150L/1		171/118.6	49.6/23.7	2800/2400	1300/1000	6500	2500	1500	2000	310	210	60
M61-250200L/1-75		179/123	51.9/24.6	5000/4200	2300/1800	8400	2500	2000	2000	390	280	90
M61-300150L/1-75		195/135	56.6/27	3400/2850	1500/1250	6800	3000	1500	2000	390	280	90
M61-450250L/1-75		267.3/184	77.53/36.8	12000/10000	5800/3500	22000	4500	2500	2000	390	280	90